

OILQUIP LIMITED

Product Brochure

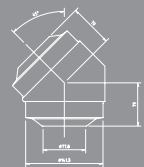

Manufacturers and Stockists of High Pressure Pipeline and Drilling Equipment

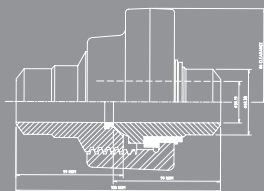
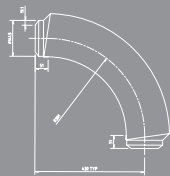
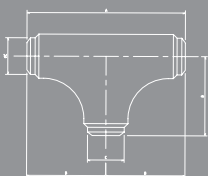

Contents

Click on a product category to navigate directly to that section:

- 1.** API Connections
- 2.** Hammer Lug Union
- 3.** Manifold Fittings
- 4.** High Pressure Couplings & Hoses
- 5.** API 6A Valves
- 6.** High Pressure Seamless Pipe
- 7.** Turnkey Manifold

1. API Connections

[**Back to
Contents Page**](#)

1. API Connections

API Flanges

Oilquip offer a large range of API 6A and ANSI forged swivel flanges, Blind flanges, slip-on flanges and weld-neck flanges in 4130 carbon steel, to suit 2" to 6" nominal bore XXS pipe with pressure rating below. The API 6A specification requires a rigorous and unique quality system including stringent dimensional and NDT control. The application of an API monogram is that you, the client will be guaranteed of total compliance with the API specifications.



Max. Working Pressure	2,000 PSI	3,000 PSI	5,000 PSI	10,000 PSI	15,000 PSI	20,000 PSI
Test Pressure	3,000 PSI	4,500 PSI	7,500 PSI	15,000 PSI	22,500 PSI	30,000 PSI
Product Specification Levels	1, 2, 3 & 4	1, 2, 3 & 4	1, 2, 3 & 4	1, 2, 3 & 4	1, 2, 3 & 4	1, 2, 3 & 4
API Temperature Rating	K (-60 Deg C)	K (-60 Deg C)	K (-60 Deg C)	K (-60 Deg C)	K (-60 Deg C)	K (-60 Deg
	To	To	To	To	To	To
	Y (+345 Deg C)	Y (+345 Deg C)	Y (+345 Deg C)	Y (+345 Deg C)	Y (+345 Deg C)	Y (+345 Deg C)

Integral, Blind, Target Blind & Test Flanges

Min. Yield	60,000 PSI	60,000 PSI	60,000 PSI	60,000 PSI	75,000 PSI	75,000 PSI
Min. Tensile	85,000 PSI	85,000 PSI	85,000 PSI	85,000 PSI	95,000 PSI	95,000 PSI
Material	API 60K	API 60K	API 60K	API 60K	API 75K	API 75K

Weld Neck Flanges

Min. Yield	45,000 PSI	45,000 PSI	45,000 PSI	60,000 PSI	75,000 PSI	75,000 PSI
Min. Tensile	70,000 PSI	70,000 PSI	70,000 PSI	85,000 PSI	95,000 PSI	95,000 PSI
Material	API 45K	API 45K	API 45K	API 60K	API 75K	API 75K

1. API Connections

Studed Blocks

Flanged studed crosses and tees are available from 2” through to 6” with pressure ratings of 5,000 psi and 10,000 psi in AISI 4130 material.

Hub & Clamp Connector

The Oilquip connector is a compact mechanical joint consisting of four basic elements:- hubs, seal ring, clamps and bolting. During assembly the hubs are pulled together under the twin wedge action of the clamp segments, the sealing action is improved due to internal pressure. Each connector requires only four bolts, which includes a 100% safety/redundancy factor. The ability of the clamp connector to withstand severe bending without leakage or periodic re-tightening, has been recognised for many years in the Offshore Industry. All materials are AISI 4130- carbon steel and meet the requirements of NACE with the following pressure ratings. The particular advantage of the connector is its ability to be disconnected quickly and avoid ‘hot work’ on site.

Max Working Pressure	2,000 PSI	3,000 PSI	5,000 PSI	10,000 PSI	15,000 PSI	20,000 PSI
Test Pressure	3,000 PSI	4,500 PSI	7,500 PSI	15,000 PSI	22,500 PSI	30,000 PSI
Production Spec Levels	1, 2, 3 & 4	1, 2, 3 & 4	1, 2, 3 & 4	1, 2, 3 & 4	1, 2, 3 & 4	1, 2, 3 & 4
API Temperature Rating	K (-60 Deg C)	K (-60 Deg C)	K (-60 Deg C)	K (-60 Deg C)	K (-60 Deg C)	K (-60 Deg C)
	To	To	To	To	To	To
	Y (+345 Deg C)	Y (+345 Deg C)	Y (+345 Deg C)	Y (+345 Deg C)	Y (+345 Deg C)	Y (+345 Deg C)
Min. Yield	60,000 PSI	60,000 PSI	60,000 PSI	60,000 PSI	75,000 PSI	75,000 PSI
Min. Tensile	85,000 PSI	85,000 PSI	85,000 PSI	85,000 PSI	95,000 PSI	95,000 PSI
Material	API 60K	API 60K	API 60K	API 60K	API 75K	API 75K

2. Hammer Lug Union

[Back to
Contents Page](#)

2. Hammer Lug Union

A full range of Hammer lug unions are available upon request from threaded Fig 200 unions through to Butt Weld Fig 2202 unions and are briefly explained as follows:

Threaded Unions

We offer various sizes of API Line Pipe Threaded Unions. The Threads are gauged with calibrated working API gauges, which are inspected regularly with API master gauges.



Butt Welded Unions

Hammer Lug Unions are available in all Fig. numbers as Butt Weld Unions as an alternative to the standard API threaded end. We mostly specialise in the highpressure unions described below. When ordering please state the required pipe schedule.

Hammer Lug Unions are available in Hydrogen Sulphide trim (Sour Gas H₂S) with either Threaded or Butt weld ends. Sour Gas Unions are manufactured in accordance with NACE Standard MR-01-75. For ease of identification Sour Gas Unions are painted green.

Figure 1002

Recommended Service for the 1002 are Cementing, testing, and choke-and-kill lines with 10,000 psi (690bar) cold working pressure on 4" sizes and 7,500 psi (517 bar) cold working pressures on 5" and 6" sizes. The main features of these unions are that they have a replaceable lip type primary seal, which protects the secondary metal to metal seal, and minimises the flow turbulence. Both Butt-weld and Threaded connections are available. The Unions are also available for sour gas service: 7,500 psi (517 bar) cold working pressure.

Figure 1502

Recommended Service for the 1502 are Cementing, testing, and choke-and-kill lines with 15,000 psi (1034bar) cold working pressure. The main features of these unions are that they have a replaceable lip type primary seal, that protects the secondary metal to metal seal, and minimises the flow turbulence. Both Butt-weld and Threaded connections are available. The Unions are also available for sour gas service: 10,000 psi (690 bar) cold working pressure, butt-weld configurations only.

2. Hammer Lug Union

Figure 2002

Recommended Service for the 2002 are Cementing, testing, and choke-and-kill lines with 20,000 psi (1380bar) cold working pressure. The main features of these unions are that they have a replaceable lip type primary seal, that protects the secondary metal to metal seal, and minimises the flow turbulence, Butt-weld connections only.

Hammer Lug Unions are available in a range of figure numbers for use with the following pressure ratings and services:

Figure No	100	200	206	400	602	1002/1004*	1003	1502	2202
-----------	-----	-----	-----	-----	-----	------------	------	------	------

Standard Service

Max Working Pressure	1,000 PSI	2,000 PSI	2,000 PSI	4,000 PSI	6,000 PSI	10,000 PSI	10,000 PSI	15,000 PSI	N/A
Max Test Pressure	1,500 PSI	3,000 PSI	3,000 PSI	6,000 PSI	9,000 PSI	15,000 PSI	15,000 PSI	22,500 PSI	N/A
Colour Code	Sub - Yellow	Sub - Grey	Sub - Grey	Sub - Red	Sub - Orange	Sub - Blue	Sub - Green	Sub - Red	N/A
	Nut - Black	Nut - Blue	Nut - Blue	Nut - Black	Nut - Black	Nut - Red	Nut - Black	Nut - Blue	N/A

Sour Service

Max Working Pressure	N/A	N/A	N/A	4,000 PSI	6,000 PSI	7,500 PSI	7,500 PSI	10,000 PSI	15,000 PSI
Max Test Pressure	N/A	N/A	N/A	6,000 PSI	9,000 PSI	11,250 PSI	11,250 PSI	15,000 PSI	22,500 PSI
Colour Code	N/A	N/A	N/A	Sub - Green	Sub - Green	Sub - Green	Sub - Green	Sub - Green	Sub - Green
	N/A	N/A	N/A	Nut - Green	Nut - Green	Nut - Green	Nut - Green	Nut - Green	Nut - Green

3. Manifold Fittings

[Back to
Contents Page](#)



3. Manifold Fittings

Full Flow High Pressure Manifold Fittings are manufactured from wrought iron steel. Crosses and Tees are closed die forges to ensure they have a correct grain flow, high integrity and uniform shape. Both 45° and 90° elbows are produced from hollow or tubular bars, hot formed on purpose made bending machines or forged in closed dies. Full ranges of fittings from 2" to 6" are available with standard pressure ratings of 5,000 psi and 10,000 psi.

Long Radius Elbows & Fittings

Oilquip elbows have been forged and not welded to ensure that the end user obtains maximum results from the equipment. The following features of Oilquip fittings enable them to be categorised in the highest standard of high-pressure equipment.

- Eliminates post weld heat treatment requirements that restrict the material's potential strength.
- Have smooth round uninterrupted bores to minimise pressure drop and turbulence.
- Inherently stronger.
- End fittings machined integrally.
- Do not require costly weld inspection.
- Fully pressure tested and certified.
- Full material tractability.

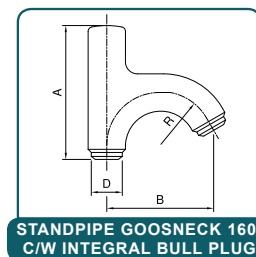
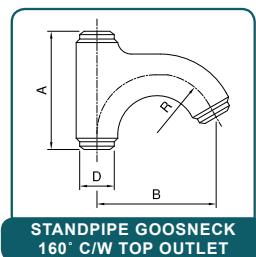
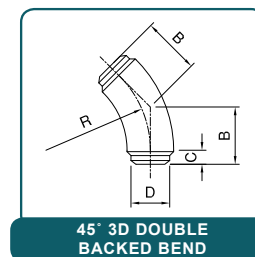
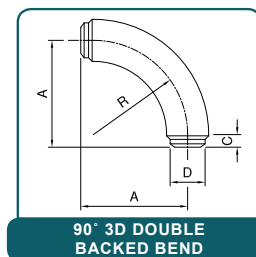
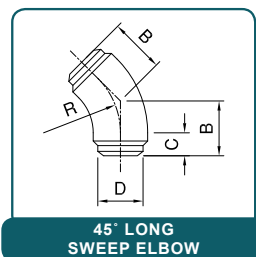
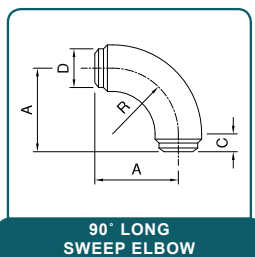
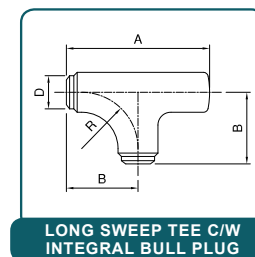
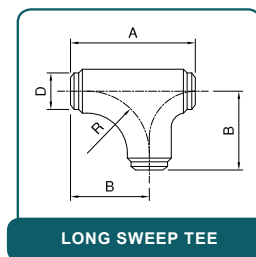
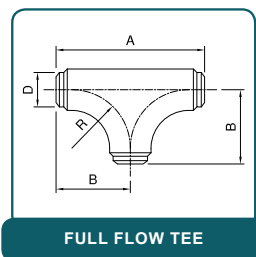
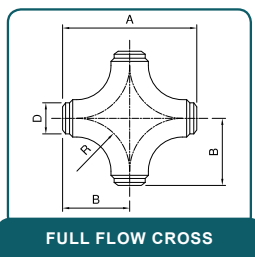

3. Manifold Fittings

SIZE	FULL FLOW CROSS				APPROX WEIGHT (Kg)
	D	A	B	R	
2"	60.3	406	203	150	54
3"	88.9	406	203	150	48
4"	114.3	560	280	210	94
5"	141.3	610	305	240	138
6"	168.3	762	381	305	208

SIZE	FULL FLOW TEE				APPROX WEIGHT (Kg)
	D	A	B	R	
2"	60.3	406	203	150	39
3"	88.9	406	203	150	33
4"	114.3	560	280	210	63
5"	141.3	610	305	240	90
6"	168.3	762	381	305	143

SIZE	LOW SWEEP TEE				APPROX WEIGHT (Kg)
	D	A	B	R	
2"	60.3	330	203	150	33
3"	88.9	330	203	150	28
4"	114.3	406	280	210	51
5"	141.3	483	305	240	76
6"	168.3	686	381	305	132

SIZE	LONG SWEEP TEE C/W INTEGRAL BULL PLUG				APPROX WEIGHT (Kg)
	D	A	B	R	
2"	60.3	406	203	150	44
3"	88.9	406	203	150	37
4"	114.3	560	280	210	71
5"	141.3	610	305	240	100
6"	168.3	762	381	305	154

SIZE	90° LONG SWEEP ELBOW				APPROX WEIGHT (Kg)
	D	A	R	C	
2"	60.3	203	150	53	20
3"	88.9	203	150	53	14
4"	114.3	280	210	70	39
5"	141.3	305	240	65	57
6"	168.3	381	505	76	105

SIZE	45° LONG SWEEP ELBOW				APPROX WEIGHT (Kg)
	D	B	R	C	
2"	60.3	118	150	56	14
3"	88.9	118	150	56	9
4"	114.3	162	210	75	26
5"	141.3	171	240	72	37
6"	168.3	203	505	76	57

SIZE	90° 3D DOUBLE BACKED BEND				APPROX WEIGHT (Kg)
	D	A	R	C	
2"	60.3	178	152	26	8
3"	88.9	305	229	76	29
4"	114.3	356	305	51	52
5"	141.3	432	381	51	87
6"	168.3	533	457	76	177

SIZE	45° 3D DOUBLE BACKED BEND				APPROX WEIGHT (Kg)
	D	B	R	C	
2"	60.3	121	152	58	7
3"	88.9	171	229	76	19
4"	114.3	177	305	51	31
5"	141.3	209	381	51	50
6"	168.3	265	457	76	89

SIZE	STANDPIPE GOOSNECK 160° C/W TOP OUTLET				APPROX WEIGHT (Kg)
	D	A	B	R	
2"	60.3	330	310	150	47
3"	88.9	330	310	150	48
4"	114.3	406	431	210	91
5"	141.3	483	487	240	133
6"	168.3	686	600	305	238

SIZE	STANDPIPE GOOSNECK 160° C/W INTEGRAL BULL PLUG				APPROX WEIGHT (Kg)
	D	A	B	R	
2"	60.3	406	310	150	48
3"	88.9	406	310	150	51
4"	114.3	560	431	210	97
5"	141.3	610	487	240	142
6"	168.3	762	600	305	255

3. Manifold Fittings

High Pressure Manifold Fittings

Manifold Fittings are available either Full Flow or with reducing configurations in all pipe wall schedules, for the following pressure ratings:

Max Working Pressure	5,000 PSI	7,500 PSI	10,000 PSI	15,000 PSI
Test Pressure (PSI)	7,500	11,250	15,000	22,500
Operating Temperature Range	-60 to +345 Deg C	-60 to +345 Deg C	-60 to +345 Deg C	-60 to +345 Deg C
Min. Yield	52,000 PSI	>80,000 PSI	>80,000 PSI	>80,000 PSI
Min. Tensile	66,000 PSI	105,000 PSI	105,000 PSI	105,000 PSI
Material	MSS-SP-75 Gr WPHY 52	ASTM A234 Gr 4130	ASTM A234 Gr 4130	ASTM A234 Gr 4130

Wrought Steel Fittings

Buttwelding Fittings are available in either equal or with reducing configurations to suit various pressure ratings using materials as shown in the table below:

Property	A234 Gr WPB	A420 Gr WPL6	A182 Gr 316L	A860 Gr WPHY52	A182 F51 31803	UNS AISI 4130
Tensile Strength	60,000 PSI	60,000 PSI	70,000 PSI	66,000 PSI	90,000 PSI	105,000 PSI
	415 MPa	415 MPa	485 MPa	455 MPa	620 MPa	725 MPa
Yield Strength	35,000 PSI	35,000 PSI	25,000 PSI	52,000 PSI	65,000 PSI	>80,000 PSI
	240 MPa	240 MPa	170 MPa	360 MPa	450 MPa	>551 MPa
Impact Values Deg C	N/A	18J min.av.	N/A	27J min.av.	27J min.av.	42J min.av.
		-45		-50	-50	-50
Hardness (Max)	197 HB	N/A	N/A	235 HB	237 HB	237 HB
Elongation In 2" or 50mm	Long: 30%	Long: 30%	30%	32%	25%	18%
	Trans: 20%	Trans: 16%				

3. Manifold Fittings

API 6A Crosses and Tees

Flanged Studded Crosses & Tees and Flanged Crosses & Tees are available either equal or with reducing configuration for use with the following pressure ratings:

Max. Working Pressure	2,000 PSI	3,000 PSI	5,000 PSI	10,000 PSI	15,000 PSI	20,000 PSI
Test Pressure	3,000 PSI	4,500 PSI	7,500 PSI	15,000 PSI	22,500 PSI	30,000 PSI
Product Specification Levels	1, 2, 3 & 4	1, 2, 3 & 4	1, 2, 3 & 4	1, 2, 3 & 4	1, 2, 3 & 4	1, 2, 3 & 4
API Temperature Rating	K (-60 Deg C)	K (-60 Deg C)	K (-60 Deg C)	K (-60 Deg C)	K (-60 Deg C)	K (-60 Deg C)
	To	To	To	To	To	To
	Y (+345 Deg C)	Y (+345 Deg C)	Y (+345 Deg C)	Y (+345 Deg C)	Y (+345 Deg C)	Y (+345 Deg C)
Min. Yield	60,000 PSI	60,000 PSI	60,000 PSI	60,000 PSI	75,000 PSI	75,000 PSI
Min. Tensile	85,000 PSI	85,000 PSI	85,000 PSI	85,000 PSI	95,000 PSI	95,000 PSI
Material	API 60K	API 60K	API 60K	API 60K	API 75K	API 75K

4. High Pressure Couplings & Hoses

[**Back to
Contents Page**](#)



4. High Pressure Couplings & Hoses

Oilquip offer a complete range of couplings including high pressure quick disconnect self healing couplings, in numerous materials of stainless steel 316L and alloy 400. Hose couplings are available ex-stock both one and two piece forms, in all threads. In addition any other couplings can be manufactured to your requirement upon request. We provide a range of fire rated control hoses with male sub & wing nut selfsealing couplings. These are also available with SAE or swivel flange connections. Quality Assurance is in accordance with DIN to the standard 50049.3.1. Oilquip can offer proof tests of up to 30,000 PSI, and burst test of up to 60,000 PSI.

All rotary and vibrator hoses are manufactured to API Spec.7.K.

The Oilquip range of hoses covers the complete Oil Industry:

- Oil exploration
- Oil production
- Oil transportation
- Oil refinery
- Oil field construction



Hoses with internal stainless steel stripwound tubes for the transportation of oil, oil-gas, gas, water, suitable for vacuum service can be designed for combined functions which can be used in the following areas of the Offshore theatre of operations.

Flowlines (acc. To API RP 17 - B bonded type) • risers • production test lines • export lines • jumper hoses, spool pieces and tie in hoses • Hydraulic pile driving hoses in long length • burner hoses • well test lines • subsea crude oil hoses.

Choke & Kill Hoses

Oilquip can provide an elastomeric flexible hoseline, which is not prone to the so-called cold flow or creep, which is inevitable with thermoplastic tube materials. The hoseline can be uniformly bent in any direction, thus meaning it can be transported and moved with the greatest of ease.

Apart from the pressure resistant lining, the high strength steel cable reinforcements and cover, there are no other special constructional elements used. The cover can be normal, flame resistant or externally armoured with an interlock stainless steel tube.

4. High Pressure Couplings & Hoses

Sizes range from 2" to 4" hose ID with working pressures of 5,000 psi and 10,000 psi.

Hoses are available in manual or remote operation for use in the following pressure ratings and services:

Pressure Ratings				
Max Working Pressure	1,500 PSI	2,000 PSI	3,000 PSI	4,000 PSI
Test Pressure	2,250 PSI	3,000 PSI	4,500 PSI	8,000 PSI

Pressure Ratings (continued)

Max Working Pressure	5,000 PSI	7,500 PSI	10,000 PSI	15,000 PSI
Test Pressure	7,530 PSI	11,250 PSI	15,000 PSI	22,500 PSI

5. API 6A Valves

[Back to
Contents Page](#)



5. API 6A Valves

Gate Valves

The through conduit gate valve has been developed to satisfy the need for a high quality, high specification valve which is reliable and reasonably priced. Oilquip gate valves make full use of modern materials and manufacturing techniques. The valve is robust, easy to maintain, conforms to international Design requirements and Quality Assurance programmes.

The gate valve conforms to all aspects stated in the API.6A Standard. Manufacture of the valve takes place in a Plant that is regularly audited by Third Party Auditing Bureaux to ensure the API.Q1 and ISO9001 are fully maintained.

The initial cost of this valve is very competitive, but the longer term saving resulting from robustness and low cost of spares makes it the most affective valve on the market today.



Gate Valves are available in manual or remote operation for use in the following pressure ratings and services:

Pressure & Temperature Ratings

Max Working Pressure	2,000 PSI	3,000 PSI	5,000 PSI	10,000 PSI	15,000 PSI	20,000 PSI
Test Pressure	3,000 PSI	4,500 PSI	7,500 PSI	15,000 PSI	22,500 PSI	30,000 PSI
Production Spec Levels	1, 2, 3 & 4	1, 2, 3 & 4	1, 2, 3 & 4	1, 2, 3 & 4	1, 2, 3 & 4	1, 2, 3 & 4
Product Rating	1 & 2	1 & 2	1 & 2	1 & 2	1 & 2	1 & 2
API Temperature Rating	K (-60 Deg C)	K (-60 Deg C)	K (-60 Deg C)	K (-60 Deg C)	K (-60 Deg C)	K (-60 Deg C)
	To	To	To	To	To	To
	Y (+345 Deg C)	Y (+345 Deg C)	Y (+345 Deg C)	Y (+345 Deg C)	Y (+345 Deg C)	Y (+345 Deg C)

5. API 6A Valves

Material Requirements

Material Class	Body, Bonnet, End and outlet Connections	Pressure Controlling Parts
AA - General Service	Carbon or Low Alloy Steel	Carbon or Low Alloy Steel
BB - General Service	Carbon or Low Alloy Steel	Stainless Steel
CC - General Service	Stainless Steel	Stainless Steel
DD - Sour Service**	Carbon or Low Alloy Steel*	Carbon or Low Alloy Steel*
EE - Sour Service**	Carbon or Low Alloy Steel*	Stainless Steel*
FF - Sour Service**	Stainless Steel*	Stainless Steel*
HH - Sour Service**	Corrosion Resistant Alloys*	Corrosion Resistant Alloy*

*In accordance with NACE MR-01-75

**As defined in NACE MR-01-75

Mud Valves

Oilquip have a solution for the increasing high-pressure demands placed upon modern drilling mud systems. By introducing a gate valve capable of working at pressures as high as 5,000psi & 7,500 psi. They are purpose made for mud, cement, fracturing and water service.

The body and bonnet of the valves are manufactured from forged steel to increase structural strength. The Oilquip valves are manufactured to conform to API 6A quality levels PSL 1, 2 or 3 and pressure tested to either API 6A or API 6D requirements. Full material tractability is guaranteed.

Valves are available in a variety of sizes from 2"-6" and can also be supplied with flange, hub, hammer unions, threaded or butt-weld ends. Sour service valves conform to the requirements of NACE MR-01-75.

API 5000PSI Mud Gate Valves

Mud Gate Valves are available for use in the following pressure ratings and services:

Pressure & Temperature Ratings

Max Working Pressure	2,000 PSI	3,000 PSI	5,000 PSI
Test Pressure	3,000 PSI	4,500 PSI	7,500 PSI
API Temperature Rating	P (-29 Deg C)	P (-29 Deg C)	P (-29 Deg C)
	To	To	To
	U (+121 Deg C)	U (+121 Deg C)	U (+121 Deg C)

5. API 6A Valves

Material Requirements

Material Class	Body, Bonnet, End and outlet Connections	Pressure Controlling Parts
AA - General Service	Carbon or Low Alloy Steel	Carbon or Low Alloy Steel
BB - General Service	Carbon or Low Alloy Steel	Stainless Steel
DD - Sour Service**	Carbon or Low Alloy Steel*	Carbon or Low Alloy Steel*
EE - Sour Service**	Carbon or Low Alloy Steel*	Stainless Steel*

*In accordance with NACE MR-01-75

**As defined in NACE MR-01-75

API 7500PSI Mud Gate Valves

Mud Gate Valves are available for use in the following pressure ratings and services:

Pressure & Temperature Ratings

Max Working Pressure	7,500 PSI (Rubber Seated)	7,500 PSI (Metal Seated)
Test Pressure	11,250 PSI	11,250 PSI
API Temperature Rating	P (-29 Deg C)	K (-60 Deg C)
	To	To
	U (+121 Deg C)	Y (+345 Deg C)

Material Requirements

Material Class	Body, Bonnet, End and outlet Connections	Pressure Controlling Parts
AA - General Service	Carbon or Low Alloy Steel	Carbon or Low Alloy Steel
BB - General Service	Carbon or Low Alloy Steel	Stainless Steel
DD - Sour Service**	Carbon or Low Alloy Steel*	Carbon or Low Alloy Steel*
EE - Sour Service**	Carbon or Low Alloy Steel*	Stainless Steel*

*In accordance with NACE MR-01-75

**As defined in NACE MR-01-75

5. API 6A Valves

API 6A Choke Valves

Choke Valves are available in manual or remote operation for use in the following pressure ratings and services:

Pressure & Temperature Ratings

Max Working Pressure	2,000 PSI	3,000 PSI	5,000 PSI	10,000 PSI	15,000 PSI	20,000 PSI
Test Pressure	3,000 PSI	4,500 PSI	7,500 PSI	15,000 PSI	22,500 PSI	30,000 PSI
Production Spec Levels	1, 2, 3 & 4	1, 2, 3 & 4	1, 2, 3 & 4	1, 2, 3 & 4	1, 2, 3 & 4	1, 2, 3 & 4
Product Rating	1 & 2	1 & 2	1 & 2	1 & 2	1 & 2	1 & 2
API Temperature Rating	K (-60 Deg C)	K (-60 Deg C)	K (-60 Deg C)	K (-60 Deg C)	K (-60 Deg C)	K (-60 Deg C)
	To	To	To	To	To	To
	Y (+345 Deg C)	Y (+345 Deg C)	Y (+345 Deg C)	Y (+345 Deg C)	Y (+345 Deg C)	Y (+345 Deg C)

Material Requirements

Material Class	Body, Bonnet, End and outlet Connections	Pressure Controlling Parts
AA - General Service	Carbon or Low Alloy Steel	Carbon or Low Alloy Steel
BB - General Service	Carbon or Low Alloy Steel	Stainless Steel
CC - General Service	Stainless Steel	Stainless Steel
DD - Sour Service**	Carbon or Low Alloy Steel*	Carbon or Low Alloy Steel*
EE - Sour Service**	Carbon or Low Alloy Steel*	Stainless Steel*
FF - Sour Service**	Stainless Steel*	Stainless Steel*
HH - Sour Service**	Corrosion Resistant Alloys*	Corrosion Resistant Alloy*

*In accordance with NACE MR-01-75

**As defined in NACE MR-01-75

API 6A Plug Valves

Plug Valves are available in either lever, gearbox or remote operation for use in the following pressure ratings and services:

Pressure & Temperature Ratings

Max Working Pressure	5,000 PSI	10,000 PSI	15,000
Test Pressure	7,500 PSI	15,000 Psi	22,500 PSI
Production Spec Levels	1, 2, 3 & 4	1, 2, 3 & 4	1, 2, 3 & 4
API Temperature Rating	P (-29 Deg C)	P (-29 Deg C)	P (-29 Deg C)
	To	To	To
	U (+121 Deg C)	U (+121 Deg C)	U (+121 Deg C)

5. API 6A Valves

Material Requirements

Material Class	Body, Bonnet, End and outlet Connections	Pressure Controlling Parts
AA - General Service	Carbon or Low Alloy Steel	Carbon or Low Alloy Steel
BB - General Service	Carbon or Low Alloy Steel	Stainless Steel
CC - General Service	Stainless Steel	Stainless Steel
DD - Sour Service**	Carbon or Low Alloy Steel*	Carbon or Low Alloy Steel*
EE - Sour Service**	Carbon or Low Alloy Steel*	Stainless Steel*
FF - Sour Service**	Stainless Steel*	Stainless Steel*

*In accordance with NACE MR-01-75

**As defined in NACE MR-01-75

6. High Pressure Seamless Pipe

[**Back to
Contents Page**](#)

6. High Pressure Seamless Pipe

To complement our range of products Oilquip, UK's leading supplier of high pressure seamless pipe have a full range of specifications for structural tubulars to A519 Gr 4130, API 5L Grade X52, X60 and X65 that are held in stock, in sizes ranging from 2" nominal bore to 6". We can supply cut lengths; long pieces and even bore from forged, machined bar to satisfy your urgent demand.

The high production quality of the pipe means that the following features are guaranteed:

- Controlled, uniform metallurgic structure.
- Homogeneous and consistent mechanical properties.
- Superior dimensional tolerances.
- Smoother outer and inner surfaces.



Oilquip offer Hot Finished Tubes and in any cross section of any one tube the eccentricity will not exceed 8%.

Pipe will be supplied in 5-7 metre random lengths with butt-weld ends and varnished to avoid oxidation of the steel when in storage. All pipes are fully certified and traceable with heat numbers hard stamped onto each random length.

Certification is at no extra charge and include standards that meet the requirements of NACE MR-01-75 known in Europe as DIN 50049 3.1.

6. High Pressure Seamless Pipe

Nominal Pipe Size	Outside Diameter	SCH 10	SCH 20	SCH 30	SCH 40 1.7 .068	SCH STD 1.7 .068	SCH 60	SCH 80 2.4 .095	SCH XS 2.4 .095	SCH 100	SCH 120	SCH 140	SCH 160	SCH XXS
6mm 1/8"	10.3mm .405"													
6mm 1/4"	13.7mm .540"				2.2 .088	2.2 .088		3.0 .119	3.0 .119					
10mm 3/8"	17.1mm .675"				2.3 .090	2.3 .090		3.2 .126	3.2 .126					
15mm 1/2"	21.3mm .840"				2.8 .109	2.8 .109		3.7 .147	3.7 .147				4.8 .187	7.5 .294
20mm 3/4"	26.7mm 1.050"				2.9 .113	2.9 .113		3.9 .154	3.9 .154				5.6 .218	7.8 .306
25mm 1"	33.4mm 1.315"				3.4 .133	3.4 .133		4.5 .179	4.5 .179				6.4 .250	9.1 .382
32mm 1"	42.2mm 1.660"				3.6 .140	3.6 .140		4.5 .191	4.5 .191				6.4 .250	10.2 .400
40mm 1 1/2"	48.3mm 1.900"				3.7 .145	3.7 .145		5.5 .200	5.5 .200				7.1 .281	11.1 .436
50mm 2"	60.3mm 2.875"				3.9 .154"	3.9 .154"		5.5 .218	5.5 .218				8.7 .343	14.0 .552
65mm 2 1/2"	73.0mm 2.875"				5.2 .203	5.2 .203		7.0 .276	7.0 .276				9.5 .375	15.2 .600
80mm 3"	86.9mm 3.500"				5.5 .216	5.5 .216		7.6 .300	7.6 .300				11.1 .438	15.9 .636
90mm 3 1/2"	101.6mm 4.00"				5.7 .226	5.7 .226		8.1 .316	8.1 .316					17.1 .674
100mm 4"	114.3mm 4.500"				6.0 .237	6.0 .237		8.6 .337	8.6 .337		11.1 .436		13.5 .531	19.1 .750
125mm 5"	141.3mm 5.563"				6.6 .258	6.6 .258		9.5 .375	9.5 .375		12.7 .500		15.9 .625	22.0 .875
150mm 6"	168.3mm 6.625"				7.1 .280	7.1 .280		11.0 .432	11.0 .432		14.3 .562		18.3 .719	25.4 1.000
200mm 8"	219.1mm 8.625"		6.4 .250	7.0 .277	8.2 .322	8.2 .322	10.3 .406	12.7 .500	12.7 .500	15.1 .594	16.3 .719	20.6 .812	23.0 .906	25.4 1.000
250mm 10"	273.0mm 10.750"		6.4 .250	7.6 .307	9.3 .365	9.3 .365	12.7 .500	15.1 .594	12.7 .500	18.3 .719	21.4 .844	25.4 1.000	26.6 1.125	
300mm 12"	323.9mm 12.750"		6.4 .250	8.4 .330	10.3 .406	9.5 .375	14.3 .562	17.5 .688	12.7 .500	21.4 .844	25.4 1.000	26.6 1.125	33.0 1.312	
350mm 14"	355.6mm 14"	6.4 .250	7.9 .312	9.5 .375	11.1 .438	9.5 .375	15.1 .594	19.1 .750	12.7 .500	23.8 .938	27.8 1.094	31.8 1.250	35.7 1.406	
400mm 16"	406.4mm 16"	6.4 .250	7.9 .312	9.5 .375	12.7 .500	9.5 .375	16.7 .656	21.4 .844	12.7 .500	26.2 1.031	30.1 1.219	36.5 1.438	40.5 1.781	
450mm 18"	457.2mm 18"	6.4 .250	7.9 .312	11.1 .438	14.3 .562	9.5 .375	19.1 .750	23.8 .938	12.7 .500	29.4 1.156	34.9 1.375	39.7 1.562	45.2 1.781	
500mm 20"	506.0mm 20"	6.4 .250	9.5 .375	12.7 .500	15.1 .594	9.5 .375	20.6 .612	26.2 1.031	12.7 .500	32.5 1.281	38.0 1.500	44.5 1.750	50.0 1.969	
600mm 24"	609.6mm 24"	6.4 .250	9.5 .375	14.3 .562	17.5 .688	9.5 .375	24.6 .968	31.0 1.218	12.7 .500	38.9 1.530	46.0 1.812	52.4 2.062	59.5 2.343	
750mm 30"	762.0mm 30"	8.0 .312	12.7 .500	16.0 .625		9.5 .375			12.7 .500					
900mm 36"	914.4mm 36"	8.0 .312	12.7 .500	16.0 .625	19.1 .750	9.5 .375			12.7 .500					

7. Turnkey Manifold

[**Back to
Contents Page**](#)

7. Turnkey Manifold

Oilquip design, manufacture, inspect and test 5000 PSI, 10000 PSI & 15000 PSI Choke & Kill Manifolds, Christmas Tree Manifolds, High Pressure Cement Manifolds and High Pressure Standpipe Manifolds.

Turnkey Manifolds Range

- Drilling Spool/ Spacer Spool
- Double Studded Adapter Spool
- Mud Pump Discharge Manifold
- Choke and Kill Manifolds Assembly
- Cement Manifolds
- StandPipe Manifolds
- Christmas Tree Manifold
- 5 Way Strainer Block and Mud Pump Discharge Manifold
- Triangle Kill Manifold
- Production Manifold

Oilquip can provide systems designed to customer specifications to ensure reliable delivery of materials as required.

By incorporating components such as Adjustable and Positive Chokes, Hydraulic Drilling Chokes, API Flanges, Hammer Lug Unions, API Studded Crossses and Tees, Adaptors, Spools, Blinds, Crossovers and Fittings, Choke Control Console, High Pressure Manifold Fittings, High Pressure Gate Valves (Manual and Hydraulic Gate Valves), High Pressure Plug Valves, Forged Crosses, Forged Tees, Forged Long Radius Elbows, Pressure Tested Assembly, Individually Pressure Tested Fittings and Gate Valves, Mud Vales, Drop Forged Manifold Fittings, Chokes, High Pressure Choke Valves, High Pressure Check Valves, Hammer Union Forged Tees and Elbows a depending on the application from our own stock availability, Oilquip can control the quality and programming of even very complex systems.

Oilquip is keen to work with clients to provide the right solution for individual projects. Where applicable or to meet client requirements and are supplied fully certified by independent third party authorities.

- API 16C Specification for Choke & Kill Systems
- API RP53 Recommended Practice for Blow Out Prevention Systems for Drilling Wells
- NPD/NMD Norwegian Petroleum Directorate / Norwegian Maritime Directorate
- API 6A Specification for Wellhead and Christmas Tree Equipment
- NACE MR-01-75 Sulphide Stress Cracking Resistant Metallic Materials for Oilfield Equipment
- Norsok Norwegian Offshore Sector

7. Turnkey Manifold

Pressure & Temperature Ratings

Max Working Pressure	5,000 PSI	7,500 PSI	10,000 PSI	15,000 PSI	20,000 PSI
Test Pressure	7,500 PSI	11,250 PSI	15,000 PSI	22,500 PSI	30,000 PSI
Production Spec Levels	1, 2, 3 & 4	1, 2, 3 & 5	1, 2, 3 & 4	1, 2, 3 & 4	1, 2, 3 & 4
Product Rating	1 & 2	2 & 2	1 & 2	1 & 2	1 & 2
API Temperature Rating	K (-60 Deg C)	K (-60 Deg C)	K (-60 Deg C)	K (-60 Deg C)	K (-60 Deg C)
	To	To	To	To	To
	Y (+345 Deg C)	Y (+345 Deg C)	Y (+345 Deg C)	Y (+345 Deg C)	Y (+345 Deg C)

Material Requirements

Material Class	Body, Bonnet, End and outlet Connections	Pressure Controlling Parts
AA - General Service	Carbon or Low Alloy Steel	Carbon or Low Alloy Steel
BB - General Service	Carbon or Low Alloy Steel	Stainless Steel
DD - Sour Service**	Carbon or Low Alloy Steel*	Carbon or Low Alloy Steel*
EE - Sour Service**	Carbon or Low Alloy Steel*	Stainless Steel*

*In accordance with NACE MR-01-75

**As defined in NACE MR-01-75

Mud Standpipe Manifold

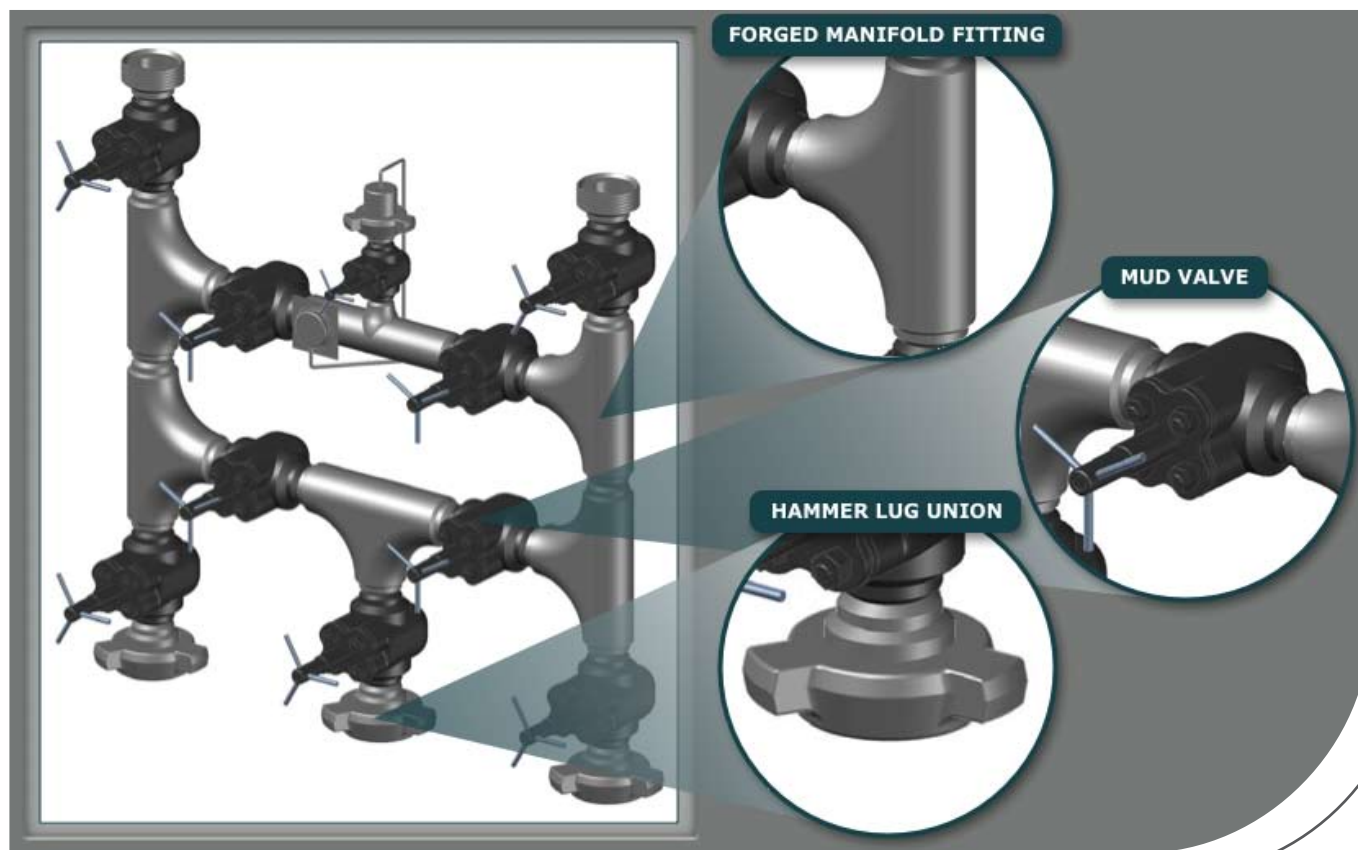

Choke & Kill Manifold

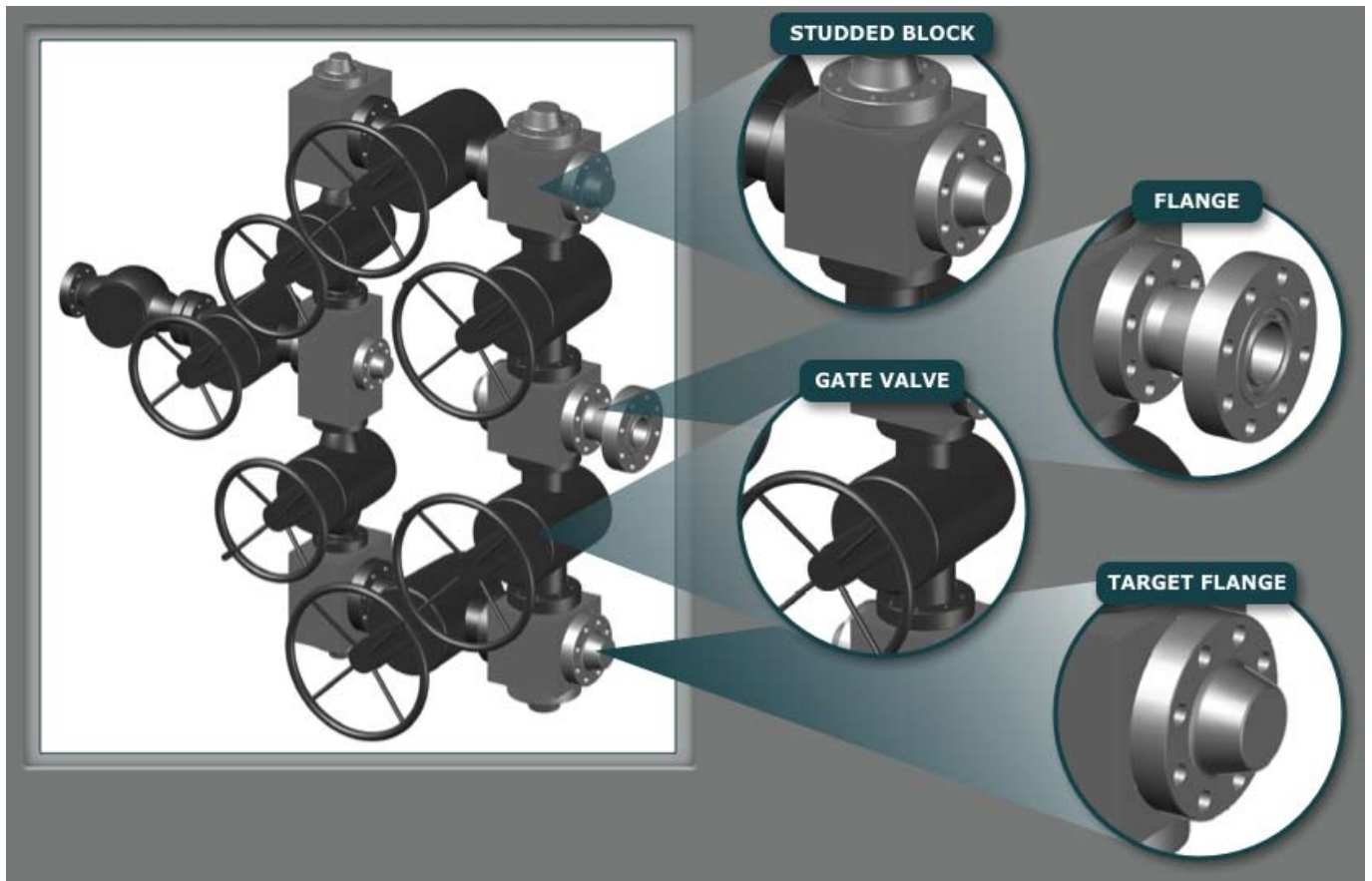

Choke & Kill Manifold

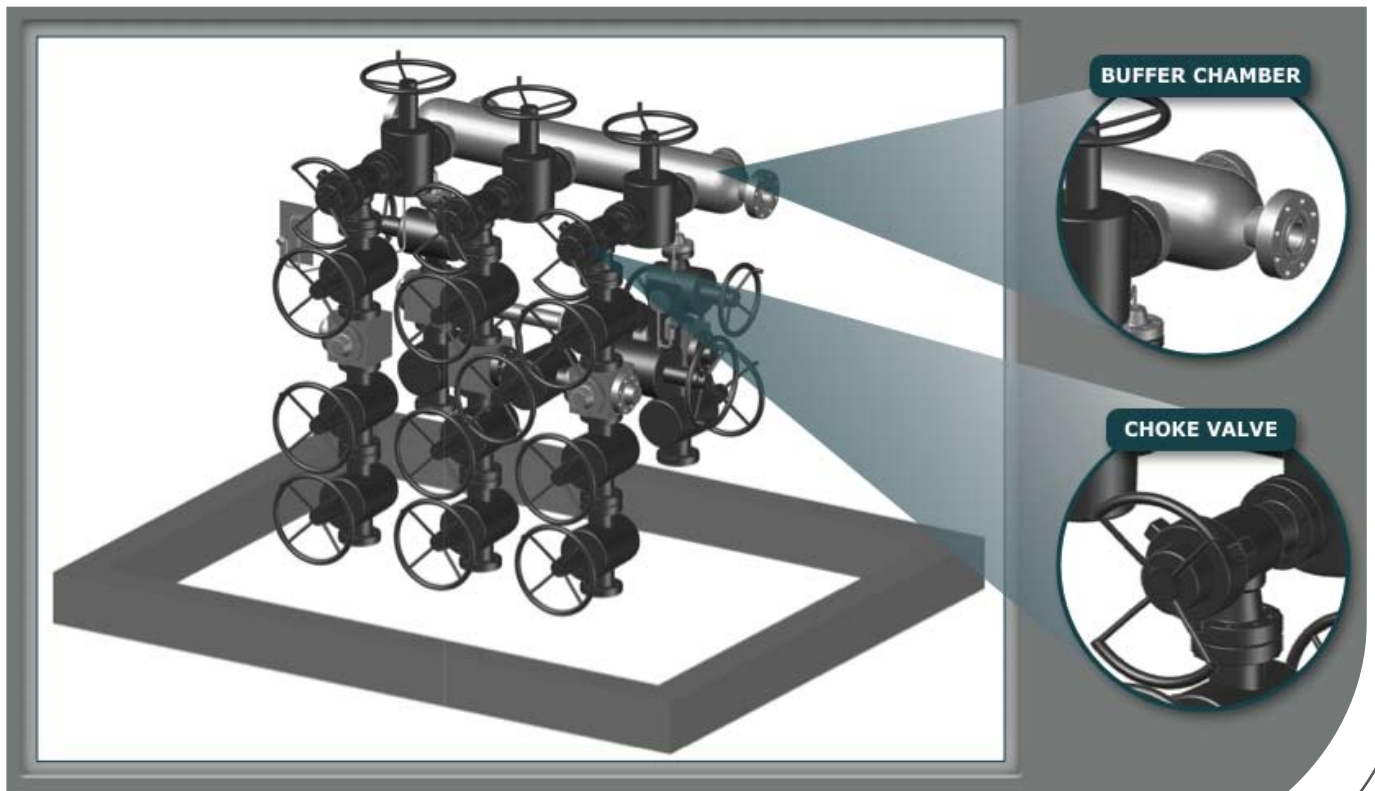



Oilquip Limited
Unit 6A/B,
Throckley Way,
Middlefield Industrial Estate,
South Shields,
Tyne & Wear
NE34 0NU
United Kingdom

Tel: +44 (0) 191 456 0466

Fax: +44 (0) 191 454 1066

Email: sales@oilquip.co.uk
